

定位珠螺絲·無頭，球防止迴轉

EH 22700.



產品描述

亦適用於固夾、上緊或支撐不完全平行的表面。
最大荷載傳遞因為可移動的球體。

材質

珠子

- 軸承鋼，硬化
- 不鏽鋼，硬化

螺絲

- 鋼，熱處理， $1200 \pm 100 \text{ N/mm}^2$
- 不鏽鋼 1.4305

更多資訊

注意事項

珠子有防止旋轉保護
特殊的樣式歡迎洽詢。

參考

需求的螺紋鎖，請參閱附錄 - 技術數據 -

更多產品

- 定位珠螺絲，無頭，有平面的球
- 定位珠螺絲，無頭，附細螺紋
- 定位珠螺絲，無頭，平面球端和梅花槽

圖面

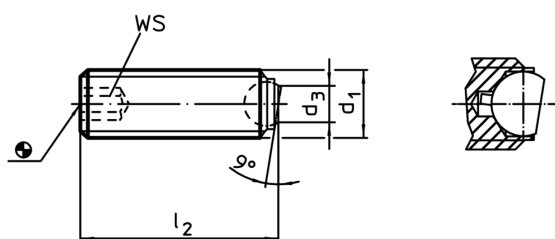

訂單資訊

d ₁	l ₂	尺寸 d ₃ [mm]	球直徑	WS [mm]	靜態荷重能力 ¹⁾ max. [kN]	 [g]	RoHS	REACH	品號
上標準夾持頭 (相片1), 熱處理鋼									
M 6	12	3,2	4,0	3	6	1,6	RoHS 認證	contains SVHC materials >0.1% w/w	22700.0563
M 6	16	3,2	4,0	3	6	2,3	RoHS 認證	contains SVHC materials >0.1% w/w	22700.0564
M 6	20	3,2	4,0	3	6	2,9	RoHS 認證	contains SVHC materials >0.1% w/w	22700.0565
M 6	25	3,2	4,0	3	6	3,8	RoHS 認證	contains SVHC materials >0.1% w/w	22700.0566
M 8	16	4,5	5,5	4	9	3,7	RoHS 認證	contains SVHC materials >0.1% w/w	22700.0583
M 8	20	4,5	5,5	4	9	5,1	RoHS 認證	contains SVHC materials >0.1% w/w	22700.0584
M 8	25	4,5	5,5	4	9	6,5	RoHS 認證	contains SVHC materials >0.1% w/w	22700.0585
M 8	30	4,5	5,5	4	9	8,1	RoHS 認證	contains SVHC materials >0.1% w/w	22700.0586
M10	20	6,0	7,0	5	12	7,6	RoHS 認證	contains SVHC materials >0.1% w/w	22700.0603

¹⁾*荷重能力報告書不適用於不銹鋼

d ₁	l ₂	尺寸 d ₃ [mm]	球直徑	WS [mm]	靜態荷重能力 ¹⁾ max. [kN]	 [g]	RoHS	REACH	品號
M10	25	6,0	7,0	5	12	10,0	RoHS 認證	contains SVHC materials >0.1% w/w	22700.0604
M10	35	6,0	7,0	5	12	15,0	RoHS 認證	contains SVHC materials >0.1% w/w	22700.0606
M10	40	6,0	7,0	5	12	17,0	RoHS 認證	contains SVHC materials >0.1% w/w	22700.0608
M12	20	7,2	8,5	6	18	11,0	RoHS 認證	contains SVHC materials >0.1% w/w	22700.0622
M12	30	7,2	8,5	6	18	18,0	RoHS 認證	contains SVHC materials >0.1% w/w	22700.0624
M12	40	7,2	8,5	6	18	24,0	RoHS 認證	contains SVHC materials >0.1% w/w	22700.0626
M12	50	7,2	8,5	6	18	32,0	RoHS 認證	contains SVHC materials >0.1% w/w	22700.0628
M16	20	10,7	12,0	8	36	22,0	RoHS 認證	contains SVHC materials >0.1% w/w	22700.0661
M16	25	10,7	12,0	8	36	28,0	RoHS 認證	contains SVHC materials >0.1% w/w	22700.0662
M16	35	10,7	12,0	8	36	38,0	RoHS 認證	contains SVHC materials >0.1% w/w	22700.0664
M16	50	10,7	12,0	8	36	60,0	RoHS 認證	contains SVHC materials >0.1% w/w	22700.0666
M20	30	13,5	15,0	10	60	52,0	RoHS 認證	contains SVHC materials >0.1% w/w	22700.0672
M20	40	13,5	15,0	10	60	70,0	RoHS 認證	contains SVHC materials >0.1% w/w	22700.0674
M20	50	13,5	15,0	10	60	90,0	RoHS 認證	contains SVHC materials >0.1% w/w	22700.0675
M20	60	13,5	15,0	10	60	111,0	RoHS 認證	contains SVHC materials >0.1% w/w	22700.0676
M24	35	15,8	18,0	12	80	86,0	RoHS 認證	contains SVHC materials >0.1% w/w	22700.0682
M24	50	15,8	18,0	12	80	125,0	RoHS 認證	contains SVHC materials >0.1% w/w	22700.0684
M24	80	15,8	18,0	12	80	216,0	RoHS 認證	contains SVHC materials >0.1% w/w	22700.0686
上標準夾持額 (相片1), 不銹鋼									
M 6	12	3,2	4,0	3	6	1,6	RoHS 認證	contains no SVHC materials	22700.0803
M 6	16	3,2	4,0	3	6	2,3	RoHS 認證	contains no SVHC materials	22700.0804
M 6	20	3,2	4,0	3	6	2,9	RoHS 認證	contains no SVHC materials	22700.0805
M 6	25	3,2	4,0	3	6	3,8	RoHS 認證	contains no SVHC materials	22700.0806
M 8	16	4,5	5,5	4	9	3,7	RoHS 認證	contains no SVHC materials	22700.0813

¹⁾*荷重能力報告書不適用於不銹鋼

d ₁	l ₂	尺寸 d ₃ [mm]	球直徑	WS [mm]	靜態荷重能力 ¹⁾ max. [kN]	 [g]	RoHS	REACH	品號
M 8	20	4,5	5,5	4	9	5,1	RoHS 認證	contains no SVHC materials	22700.0814
M 8	25	4,5	5,5	4	9	6,5	RoHS 認證	contains no SVHC materials	22700.0815
M 8	30	4,5	5,5	4	9	8,1	RoHS 認證	contains no SVHC materials	22700.0816
M10	20	6,0	7,0	5	12	7,6	RoHS 認證	contains no SVHC materials	22700.0823
M10	25	6,0	7,0	5	12	10,0	RoHS 認證	contains no SVHC materials	22700.0824
M10	35	6,0	7,0	5	12	15,0	RoHS 認證	contains no SVHC materials	22700.0826
M10	40	6,0	7,0	5	12	17,0	RoHS 認證	contains no SVHC materials	22700.0828
M12	20	7,2	8,5	6	18	11,0	RoHS 認證	contains no SVHC materials	22700.0832
M12	30	7,2	8,5	6	18	18,0	RoHS 認證	contains no SVHC materials	22700.0834
M12	40	7,2	8,5	6	18	24,0	RoHS 認證	contains no SVHC materials	22700.0836
M12	50	7,2	8,5	6	18	32,0	RoHS 認證	contains no SVHC materials	22700.0838
M16	20	10,7	12,0	8	36	22,0	RoHS 認證	contains no SVHC materials	22700.0841
M16	25	10,7	12,0	8	36	28,0	RoHS 認證	contains no SVHC materials	22700.0842
M16	35	10,7	12,0	8	36	38,0	RoHS 認證	contains no SVHC materials	22700.0844
M16	50	10,7	12,0	8	36	60,0	RoHS 認證	contains no SVHC materials	22700.0846
上交換式夾持頭 (相片2), 熱處理鋼									
M 8	16	4,5	5,5	4	9	3,7	RoHS 認證	contains SVHC materials >0.1% w/w	22700.0693
M 8	20	4,5	5,5	4	9	4,9	RoHS 認證	contains SVHC materials >0.1% w/w	22700.0694
M 8	25	4,5	5,5	4	9	6,6	RoHS 認證	contains SVHC materials >0.1% w/w	22700.0695
M 8	30	4,5	5,5	4	9	8,0	RoHS 認證	contains SVHC materials >0.1% w/w	22700.0696
M10	20	6,0	7,0	5	12	7,5	RoHS 認證	contains SVHC materials >0.1% w/w	22700.0703
M10	25	6,0	7,0	5	12	9,9	RoHS 認證	contains SVHC materials >0.1% w/w	22700.0704
M10	35	6,0	7,0	5	12	15,0	RoHS 認證	contains SVHC materials >0.1% w/w	22700.0706
M10	40	6,0	7,0	5	12	17,0	RoHS 認證	contains SVHC materials >0.1% w/w	22700.0708
M12	20	7,2	8,5	6	18	11,0	RoHS 認證	contains SVHC materials >0.1% w/w	22700.0722
M12	30	7,2	8,5	6	18	18,0	RoHS 認證	contains SVHC materials >0.1% w/w	22700.0724
M12	40	7,2	8,5	6	18	24,0	RoHS 認證	contains SVHC materials >0.1% w/w	22700.0726

¹⁾*荷重能力報告書不適用於不銹鋼

d ₁	l ₂	尺寸 d ₃ [mm]	球直徑	WS [mm]	靜態荷重能力 ¹⁾ max. [kN]	 [g]	RoHS 認證	REACH	品號
M12	50	7,2	8,5	6	18	32,0	RoHS 認證	contains SVHC materials >0.1% w/w	22700.0728
M16	20	10,7	12,0	8	36	22,0	RoHS 認證	contains SVHC materials >0.1% w/w	22700.0761
M16	25	10,7	12,0	8	36	27,0	RoHS 認證	contains SVHC materials >0.1% w/w	22700.0762
M16	35	10,7	12,0	8	36	38,0	RoHS 認證	contains SVHC materials >0.1% w/w	22700.0764
M16	50	10,7	12,0	8	36	60,0	RoHS 認證	contains SVHC materials >0.1% w/w	22700.0766
M20	30	13,5	15,0	10	60	51,0	RoHS 認證	contains SVHC materials >0.1% w/w	22700.0772
M20	40	13,5	15,0	10	60	69,0	RoHS 認證	contains SVHC materials >0.1% w/w	22700.0774
M20	50	13,5	15,0	10	60	90,0	RoHS 認證	contains SVHC materials >0.1% w/w	22700.0775
M20	60	13,5	15,0	10	60	110,0	RoHS 認證	contains SVHC materials >0.1% w/w	22700.0776
M24	35	15,8	18,0	12	80	84,0	RoHS 認證	contains SVHC materials >0.1% w/w	22700.0782
M24	50	15,8	18,0	12	80	128,0	RoHS 認證	contains SVHC materials >0.1% w/w	22700.0784
M24	80	15,8	18,0	12	80	215,0	RoHS 認證	contains SVHC materials >0.1% w/w	22700.0786

¹⁾*荷重能力報告書不適用於不銹鋼

應用範例

