

軸環螺帽· DIN 6331 (高1.5d) EH 23080.

產品描述



材質

- 鋼，quality 10，磷酸鹽處理
- 不鏽鋼 1.4305

更多資訊

參考

有關起始扭力和穩定性請參考附件 - 技術資料 -

圖面

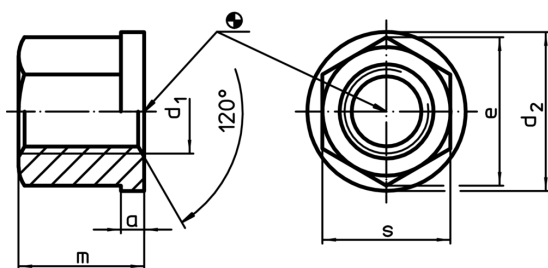

訂單資訊

d ₁	a	尺寸 d ₂ [mm]	e	m	s	 [g]	RoHS	REACH	品號
熱處理鋼									
M 6	3,0	14	11,5	9	10	5,4	RoHS 認證	contains no SVHC materials	23080.0006
M 8	3,5	18	15,0	12	13	12,0	RoHS 認證	contains no SVHC materials	23080.0008
M10	4,0	22	18,5	15	16	22,0	RoHS 認證	contains no SVHC materials	23080.0010
M12	4,0	25	20,8	18	18	30,0	RoHS 認證	contains no SVHC materials	23080.0012
M14	4,5	28	24,2	21	21	47,0	RoHS 認證	contains no SVHC materials	23080.0014 ¹⁾
M16	5,0	31	27,7	24	24	67,0	RoHS 認證	contains no SVHC materials	23080.0016
M18	5,5	34	31,2	27	27	97,0	RoHS 認證	contains no SVHC materials	23080.0018 ¹⁾
M20	6,0	37	34,6	30	30	129,0	RoHS 認證	contains no SVHC materials	23080.0020
M22	6,0	40	39,3	33	34	179,0	RoHS 認證	contains no SVHC materials	23080.0022 ¹⁾
M24	6,0	45	41,6	36	36	213,0	RoHS 認證	contains SVHC materials >0.1% w/w	23080.0024
M30	8,0	58	53,1	45	46	468,0	RoHS 認證	contains no SVHC materials	23080.0030
M36	10,0	68	63,5	54	55	783,0	RoHS 認證	contains no SVHC materials	23080.0036

¹⁾ DIN 標準不包含這些尺寸。

²⁾ DIN標準沒有包含這些材質。

d ₁	a	尺寸				s	[g]	RoHS	REACH	品號
		d ₂	e	m	[mm]					
不銹鋼										
M 8	3,5	18	15,0	12	13	12,0	RoHS 認證	contains no SVHC materials	23080.0108 ²⁾	
M10	4,0	22	18,5	15	17	25,0	RoHS 認證	contains no SVHC materials	23080.0110 ²⁾	
M12	4,0	25	20,8	18	19	36,0	RoHS 認證	contains no SVHC materials	23080.0112 ²⁾	
M16	5,0	31	27,7	24	24	70,0	RoHS 認證	contains no SVHC materials	23080.0116 ²⁾	
M20	6,0	37	34,6	30	30	130,0	RoHS 認證	contains no SVHC materials	23080.0120 ²⁾	

¹⁾ DIN 標準不包含這些尺寸。

²⁾ DIN標準沒有包含這些材質。

應用範例

